

FRONT DOOR OUTER PANEL (ASSY)**REMOVAL**

Cut and Join Location

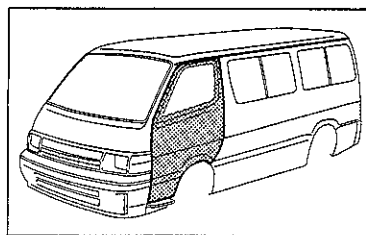
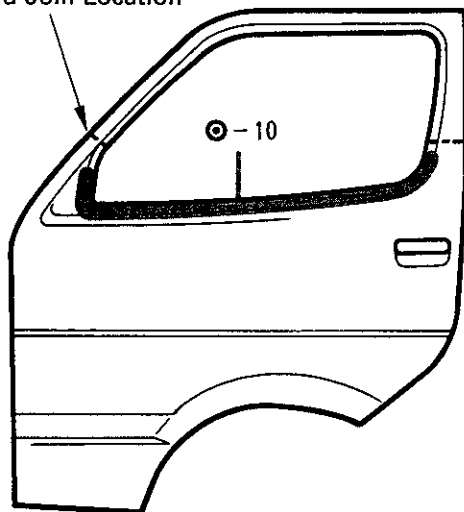

⊙ - 10

Cut and Join Location

Hemming Location

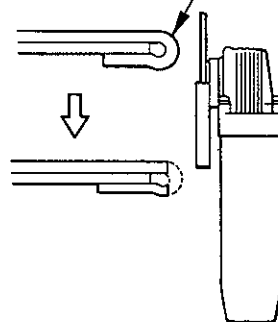

Disc Sander

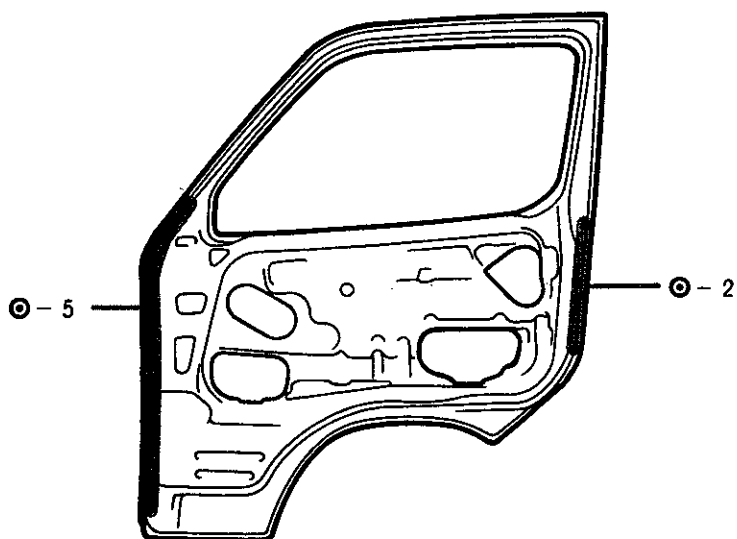

1. After grinding off the hemming location, remove the outer panel.
2. Cut and join the parts at the locations shown above.

INSTALLATION

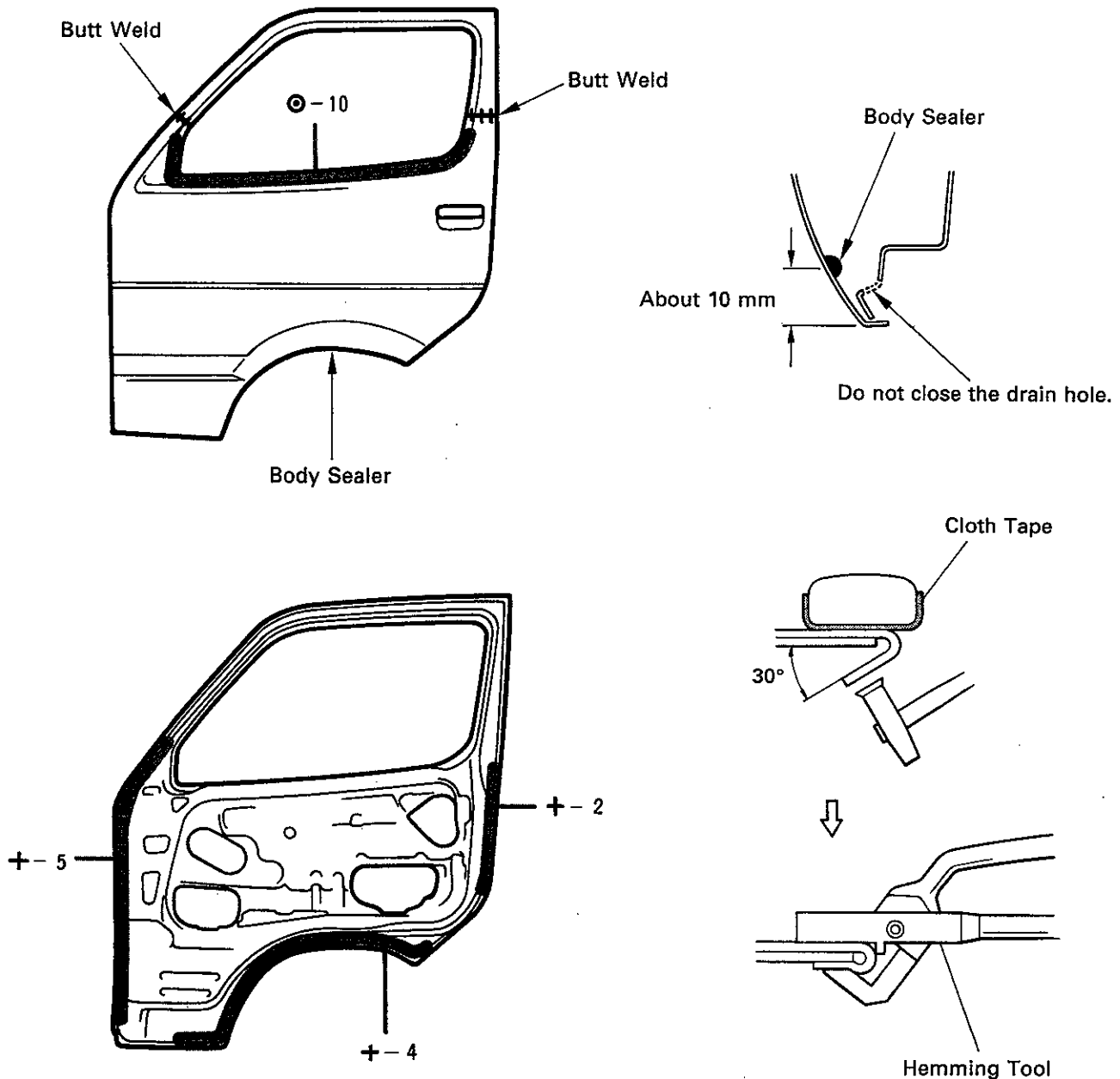

1. Before temporarily installing the new parts, apply body sealer to the back side of the new parts.

HINT:

- 1) Apply sealer evenly about 10 mm (0.39 in.) from the flange and 3 mm (0.12 in.) in diameter.
- 2) For other sealing points refer to section AR.

2. Bend the flange hem about 30° with a hammer and dolly, then fasten tightly with a hemming tool.

HINT:

- 1) Perform hemming in three steps, being careful not to warp the panel.
- 2) If a hemming tool cannot be used, hem with a hammer and dolly.